

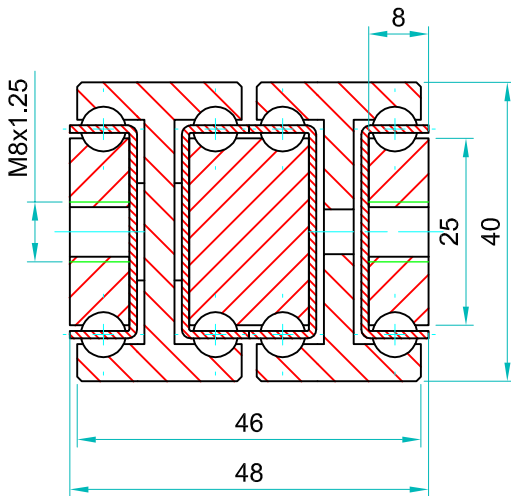

M8 threaded holes on both inner beams for bolting into

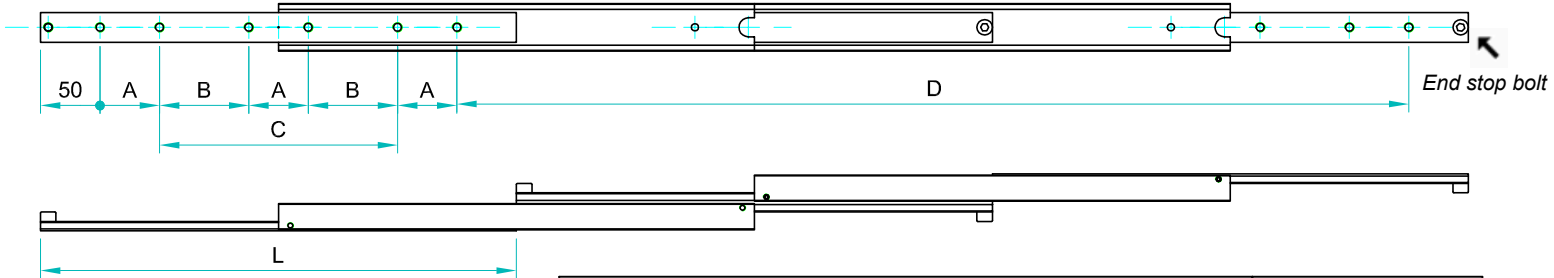

SDDTS-40 weighs 11.32 kg/m. Sold as singles

Part Number	Closed Length: L	Extension Length: D	Load per Pair: kg	Drilling pattern		
				"A"	"B"	"C"
4015.SDDTS040.0200	200	400	78	50	-	-
4015.SDDTS040.0250	250	500	83	50	-	50
4015.SDDTS040.0300	300	600	87	50	-	100
4015.SDDTS040.0350	350	700	91	50	-	150
4015.SDDTS040.0400	400	800	96	50	-	200
4015.SDDTS040.0450	450	900	93	50	-	250
4015.SDDTS040.0500	500	1000	90	50	-	300
4015.SDDTS040.0550	550	1100	87	50	150	-
4015.SDDTS040.0600	600	1200	84	50	175	-
4015.SDDTS040.0650	650	1300	81	50	200	-
4015.SDDTS040.0700	700	1400	78	50	225	-
4015.SDDTS040.0750	750	1500	75	50	250	-
4015.SDDTS040.0800	800	1600	72	50	275	-
4015.SDDTS040.0850	850	1700	69	50	300	-
4015.SDDTS040.0900	900	1800	66	50	325	-
4015.SDDTS040.0950	950	1900	63	50	350	-
4015.SDDTS040.1000	1000	2000	60	50	375	-
4015.SDDTS040.1050	1050	2100	57	50	400	-
4015.SDDTS040.1100	1100	2200	54	50	425	-
4015.SDDTS040.1150	1150	2300	51	50	450	-
4015.SDDTS040.1200	1200	2400	48	50	475	-



If mounting on the indirect axis, flat, as in the image above, reduce the load capacity by 60-80% and allow for increased deflection, or contact our engineers to request accurate FEA load analysis for OEM projects. We load rate per fully extended pair of slides on the direct axis, upright, with uniform loading across the beams. If load capacities need to be increased, please contact us for technical advice.

Material: All austenitic stainless steel parts

Beams: Stainless 316L (1.4404) precision milled

Ball bearings: Stainless 316L (1.4404)

Ball cages: Stainless 316L (1.4404)

End bolts & stopping pins: Stainless A2 304 (1.4301)

Surface treatment: Polished

Temperature range: Cryogenic to $\approx 800^{\circ}$ C with suitable lubrication & material yield strength reduction

Lubrication: We apply and recommend lithium based EP3 grease for general applications. High & low temp grease upon request

Thread pitches: As per end profile image - coarse

Options:

'F' - One mounting beam countersunk

'FF' - Both beams countersunk

'V' - V shaped raceways (bi-directional slides)

Bespoke length, drilling pattern & extension on request

Do not dismantle the slide!



The maximum safe working load is stated for a fully extended pair of slides, mounted upright.

Use all fixing holes and spread the load evenly across the inner beam.

Flat mounting: Reduce the load by 60-80%.

We recommend the use of strong L brackets for under or floor mount.

Deflection is calculated at approx 1% of the closed length, at or near full load capacity.