

Full traversing is 2 x D when the slide is mounted in the open position

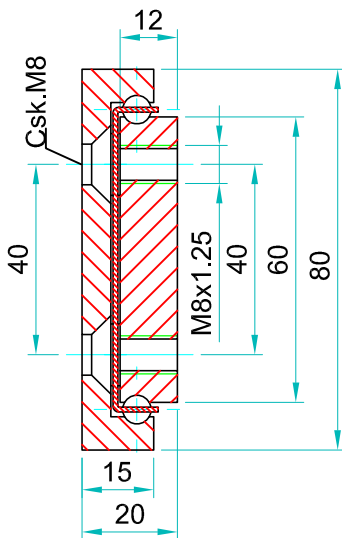

OWST-80 weighs 10.69kg/m. Sold as singles				Drilling Pattern		
Part Number	Closed Length: L	Extension Length: L	Load per Pair: kg	"A"	"B"	"C"
4015.OWST080.0200	200	200	850	50	-	-
4015.OWST080.0250	250	250	920	50	-	50
4015.OWST080.0300	300	300	960	50	-	100
4015.OWST080.0350	350	350	980	50	-	150
4015.OWST080.0400	400	400	1000	50	-	200
4015.OWST080.0450	450	450	1030	50	-	250
4015.OWST080.0500	500	500	1080	50	-	300
4015.OWST080.0550	550	550	1110	50	150	-
4015.OWST080.0600	600	600	1150	50	175	-
4015.OWST080.0650	650	650	1180	50	200	-
4015.OWST080.0700	700	700	1210	50	225	-
4015.OWST080.0750	750	750	1190	50	250	-
4015.OWST080.0800	800	800	1160	50	275	-
4015.OWST080.0850	850	850	1110	50	300	-
4015.OWST080.0900	900	900	1070	50	325	-
4015.OWST080.0950	950	950	1030	50	350	-
4015.OWST080.1000	1000	1000	970	50	375	-

**Professional Range - Steel**  
**Bi-Directional Telescopic Slide**

**Type: OWST-80**

Version: 2021/1

**OWST-80**



Options:

- 'F' - One mounting beam countersunk
- 'FF' - Both beams countersunk
- 'SB' - Stainless steel 316L ball bearings
- 'SC' - Stainless steel ball cages
- 'SA' - Stainless end bolts & retaining pins
- 'V' - V shaped raceways (bi-directional slides)
- '70' - 70% over-extension of standard slide

**Bespoke length, drilling pattern & extension on request**

OWST-80 weighs 10.69kg/m. Sold as singles				Drilling Pattern		
Part Number	Closed Length: L	Extension Length: L	Load per Pair: kg	"A"	"B"	"C"
4015.OWST080.1050	1050	1050	960	50	400	-
4015.OWST080.1100	1100	1100	940	50	425	-
4015.OWST080.1150	1150	1150	910	50	450	-
4015.OWST080.1200	1200	1200	880	50	475	-
4015.OWST080.1250	1250	1250	840	50	500	-
4015.OWST080.1300	1300	1300	800	50	525	-
4015.OWST080.1350	1350	1350	770	50	550	-
4015.OWST080.1400	1400	1400	740	50	575	-
4015.OWST080.1450	1450	1450	700	50	600	-
4015.OWST080.1500	1500	1500	650	50	625	-
4015.OWST080.1550	1550	1550	630	50	650	-
4015.OWST080.1600	1600	1600	600	50	675	-
4015.OWST080.1650	1650	1650	580	50	700	-
4015.OWST080.1700	1700	1700	560	100	650	-
4015.OWST080.1750	1750	1750	550	100	675	-
4015.OWST080.1800	1800	1800	530	100	700	-
4015.OWST080.1850	1850	1850	510	100	725	-
4015.OWST080.1900	1900	1900	490	100	750	-
4015.OWST080.1950	1950	1950	470	100	775	-
4015.OWST080.2000	2000	2000	450	100	800	-

**Do not dismantle the slide!**

The maximum safe working load is stated for a fully extended pair of slides, mounted upright. Use all fixing holes and spread the load evenly across the inner beam.

Flat mounting: Reduce the load by 60-80%. We recommend the use of strong L brackets for under or floor mount.

Deflection is calculated at approx 1% of the closed length, at or near full load capacity.



If mounting on the indirect axis, flat, as in the image above, reduce the load capacity by 60-80% and allow for increased deflection, or contact our engineers to request accurate FEA load analysis for OEM projects. We load rate per fully extended pair of slides on the direct axis, upright, with uniform loading across the beams. If load capacities need to be increased, please contact us for technical advice.

**Material:** All steel parts/no plastics

**Beams:** Cold drawn carbon steel C45E+C. EN 10277 milled raceways

**Ball bearings:** Chromed steel C85, G100. Din 5401

**Ball cages:** Zinc plated sheet steel. Laser cut profiles

**End bolts:** Steel ASTM A307

**Surface Protection:** Electrolytic alkaline zinc coating (10-12 microns). conforming to DIN EN ISO 9227 neutral salt spray testing. No white rust appearance within 120 hours. No red rust within 1,032 hours

**Temperature range:** Steel slides -20°C to +250°C provided the necessary lubricants are applied and the beams are mounted freely to allow expansion

**Lubrication:** We apply and recommend lithium based EP3 grease for general applications. High & low temp grease upon request

**Thread pitches:** As per end profile image - coarse



**'Global Company, Global Reach'**