

Full traversing is 2 x D when the slide is mounted in the open position

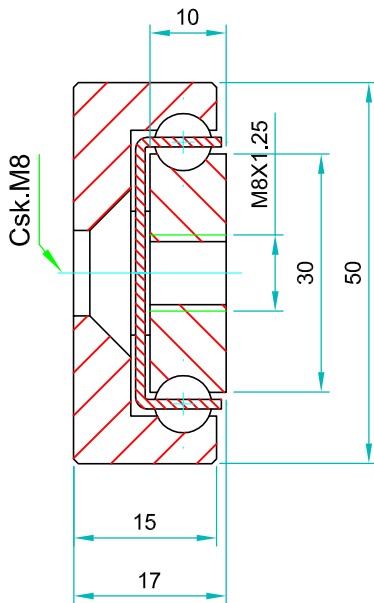

OWST-50 weighs 5.53kg/m. Sold as singles				Drilling Pattern		
Part Number	Closed Length: L	Extension Length: D	Load per Pair: kg	"A"	"B"	"C"
4015.OWST050.0150	150	150	310	50	-	-
4015.OWST050.0200	200	200	330	50	-	-
4015.OWST050.0250	250	250	340	50	-	50
4015.OWST050.0300	300	300	360	50	-	100
4015.OWST050.0350	350	350	380	50	-	150
4015.OWST050.0400	400	400	400	50	-	200
4015.OWST050.0450	450	450	420	50	-	250
4015.OWST050.0500	500	500	440	50	-	300
4015.OWST050.0550	550	550	460	50	150	-
4015.OWST050.0600	600	600	470	50	175	-
4015.OWST050.0650	650	650	480	50	200	-
4015.OWST050.0700	700	700	485	50	225	-
4015.OWST050.0750	750	750	475	50	250	-
4015.OWST050.0800	800	800	460	50	275	-
4015.OWST050.0850	850	850	450	50	300	-
4015.OWST050.0900	900	900	435	50	325	-
4015.OWST050.0950	950	950	420	50	350	-
4015.OWST050.1000	1000	1000	400	50	375	-
4015.OWST050.1050	1050	1050	385	50	400	-
4015.OWST050.1100	1100	1100	365	50	425	-
4015.OWST050.1150	1150	1150	340	50	450	-
4015.OWST050.1200	1200	1200	320	50	475	-

Professional Range - Steel
Bi-Directional Telescopic Slide

OWST-50



Type: OWST-50

Version: 2021/1

Options:

- 'F' - One mounting beam countersunk
- 'FF' - Both beams countersunk
- 'SB' - Stainless steel 316L ball bearings
- 'SC' - Stainless steel ball cages
- 'SA' - Stainless end bolts & retaining pins
- 'V' - V shaped raceways (bi-directional slides)
- '70' - 70% over-extension of standard slide

Bespoke length, drilling pattern & extension on request

Do not dismantle the slide!



The maximum safe working load is stated for a fully extended pair of slides, mounted upright. Use all fixing holes and spread the load evenly across the inner beam.

Flat mounting: Reduce the load by 60-80%.

We recommend the use of strong L brackets for under or floor mount.

Deflection is calculated at approx 1% of the closed length, at or near full load capacity.

OWST-50 weighs 5.53kg/m. Sold as singles				Drilling Pattern		
Part Number	Closed Length: L	Extension Length: D	Load per Pair: kg	"A"	"B"	"C"
4015.OWST050.1250	1250	1250	300	50	-	-
4015.OWST050.1300	1300	1300	280	50	-	-
4015.OWST050.1350	1350	1350	270	50	-	50
4015.OWST050.1400	1400	1400	260	50	-	100
4015.OWST050.1450	1450	1450	250	50	-	150
4015.OWST050.1500	1500	1500	240	50	-	200
4015.OWST050.1550	1550	1550	230	50	-	250
4015.OWST050.1600	1600	1600	220	50	-	300
4015.OWST050.1650	1650	1650	200	50	150	-
4015.OWST050.1700	1700	1700	180	50	175	-
4015.OWST050.1750	1750	1750	160	50	200	-
4015.OWST050.1800	1800	1800	140	50	225	-
4015.OWST050.1850	1850	1850	120	50	250	-
4015.OWST050.1900	1900	1900	100	50	275	-
4015.OWST050.1950	1950	1950	80	50	300	-
4015.OWST050.2000	2000	2000	70	50	325	-



If mounting on the indirect axis, flat, as in the image above, reduce the load capacity by 60-80% and allow for increased deflection, or contact our engineers to request accurate FEA load analysis for OEM projects. We load rate per fully extended pair of slides on the direct axis, upright, with uniform loading across the beams. If load capacities need to be increased, please contact us for technical advice.

Material: All steel parts/no plastics

Beams: Cold drawn carbon steel C45E+C. EN 10277 milled raceways

Ball bearings: Chromed steel C85, G100. Din 5401

Ball cages: Zinc plated sheet steel. Laser cut profiles

End bolts: Steel ASTM A307

Surface Protection: Electrolytic alkaline zinc coating (10-12 microns). conforming to DIN EN ISO 9227 neutral salt spray testing. No white rust appearance within 120 hours. No red rust within 1,032 hours

Temperature range: Steel slides -20°C to +250°C provided the necessary lubricants are applied and the beams are mounted freely to allow expansion

Lubrication: We apply and recommend lithium based EP3 grease for general applications. High & low temp grease upon request

Thread pitches: As per end profile image - coarse



'Global Company, Global Reach'