

4005.UTISLD

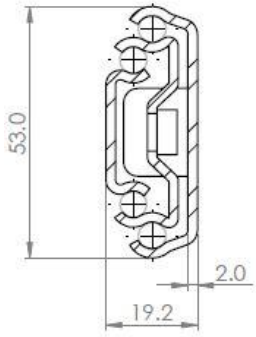

Part Number	Installation Length "A"	Extension Length "B"	Drilling Details									Load Per Pair (kg)	
			"C"	"D"	"E"	"F"	"G"	"H"	"I"	"J"	"K"		"L"
4005.UTISLD.040	400	400	285	349					147	339			100
4005.UTISLD.045	450	450	207	335	399				179	371			100
4005.UTISLD.050	500	500	225	385	449				211	435			100
4005.UTISLD.055	550	550	243	435	499				211	467			100
4005.UTISLD.060	600	600	133	293	485	549			243	531			100
4005.UTISLD.065	650	650	151	311	535	599			275	435	563		100
4005.UTISLD.070	700	700	169	329	457	585	649		275	467	627		90
4005.UTISLD.075	750	750	187	347	507	635	699		275	499	659		85
4005.UTISLD.080	800	800	205	365	557	685	749		275	531	723		80
4005.UTISLD.120	1200	1200	253	477	669	957	1085	1149	275	595	915	1139	50

Options: Various dimensions of the main profile, slide lengths, extensions, drillings and hole centres to customer requirements

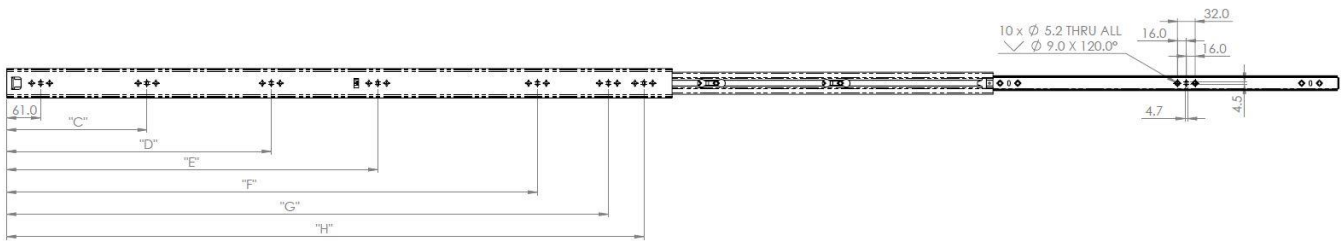
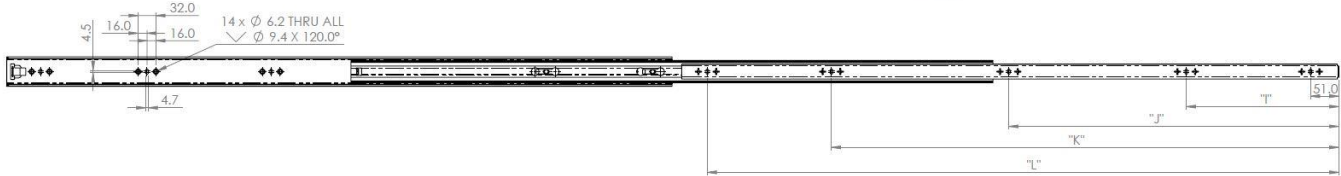

We recommend use the major axis, do not dismantle the slide! The maximum safe load is given for a fully extended pair of slides, mounted on the major axis, with a load spread uniformly along the inner beam.

Material: Beams – rolled steel. Ball cages - pressed steel. Bearings - chromed steel. Plating is bright zinc chromate as standard, with an optional black passivation (subject to MOQ).

Designation: NEN - EN 12329-Fe/Zn5/F/T2. Layer thickness: Average 5µm. Corrosion resistance: Minimum 120 hours neutral salt spray (ISO-9227/ASTM- B 117) before zinc corrosion (white) occurs. ROHS compliant.

'UK Company, Global Reach'