

TPE43
PARTIAL EXTENSION

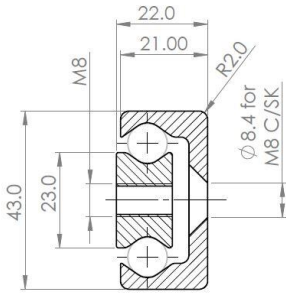

Mounting details

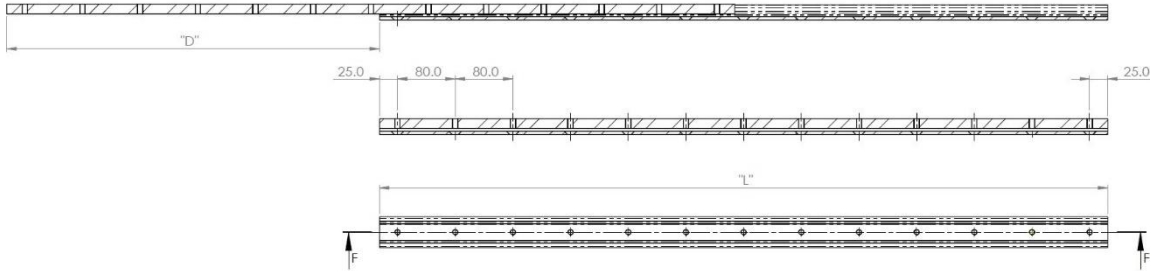
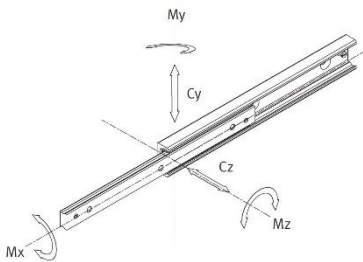

Configuration & Load Table								
Part Number	Installation Length "L"	Extension Length "D"	Load Capacity					C100 (N)
			Cy (N)	Cz (N)	Mx (N)	My (N)	Mz(N)	
4080.TPE43.0210	210	123	1596	1118	61	85	121	2288
4080.TPE43.0290	290	158	2873	2012	94	202	289	4055
4080.TPE43.0370	370	208	3378	2365	116	307	441	4794
4080.TPE43.0450	450	243	4691	3285	150	510	730	6602
4080.TPE43.0530	530	278	6040	4228	185	763	1089	8451
4080.TPE43.0610	610	313	7412	5189	216	1065	1520	10325
4080.TPE43.0690	690	363	7865	5506	238	1295	1850	11007
4080.TPE43.0770	770	398	9233	6465	273	1682	2403	12879
4080.TPE43.0850	850	433	10617	7132	305	2120	3029	14763
4080.TPE43.0930	930	483	11056	7740	328	2440	3485	15430
4080.TPE43.1010	1010	518	12435	8705	360	2962	4231	17311
4080.TPE43.1090	1090	568	12878	9015	383	3336	4767	1981
4080.TPE43.1170	1170	603	14256	9980	416	3945	5635	19861

Load capacity are stated per single extended slide Axial (Y) & Coaxial (Z) in Newtons

Options: Various dimensions of the main profile, slide lengths, extensions, drillings and hole centres to customer requirements



We recommend use the major axis, do not dismantle the slide! The maximum safe load is given for a fully extended pair of slides, mounted on the major axis, with a load spread uniformly along the inner beam.

- Material:** Beams: Cold drawn steel CF53
- Induction hardened raceways 58+4 HRC
- Depth of hardening: Min 0.8mm
- Black zinc passivate corrosion protection
- Four point bearing contact bearings with zero clearance
- Bearings: GCr15 60+4 HRC, Cage material: SPCC
- Two way travel by removal of stop screw
- Max operational temp: 170 degs C (+hi-temp lube)
- Max operating speed: 0.8 m/s
- We recommend external stops are used during operation

'UK Company, Global Reach'

TPE43
PARTIAL EXTENSION

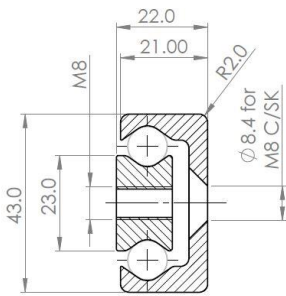
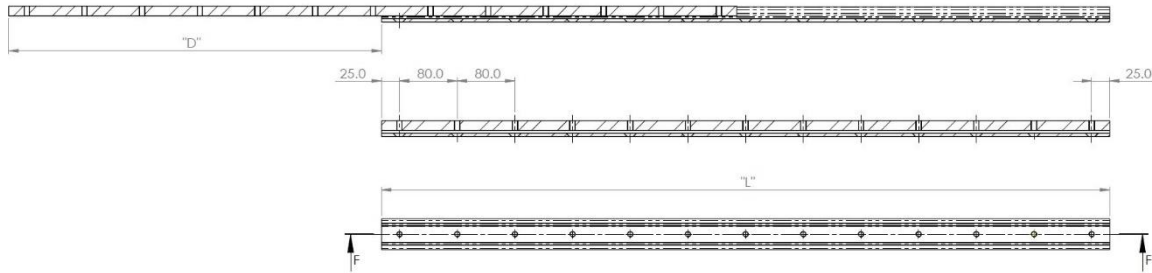

Mounting details

Configuration & Load Table								
Part Number	Installation Length "L"	Extension Length "D"	Load Capacity					C100 (N)
			Cy (N)	Cz (N)	Mx (N)	My (N)	Mz(N)	
4080.TPE43.1170	1170	603	14256	9980	416	3945	5635	19861
4080.TPE43.1250	1250	638	15640	10948	450	4597	6572	21749
4080.TPE43.1330	1330	688	16076	11255	471	5066	7238	22412
4080.TPE43.1410	1410	723	17458	12220	504	5806	8296	24298
4080.TPE43.1490	1490	758	18848	13192	538	6599	9426	26187
4080.TPE43.1570	1570	793	20240	14168	571	7442	10630	28085
4080.TPE43.1650	1650	843	20663	14465	593	8031	11473	28735
4080.TPE43.1730	1730	878	22055	15438	626	8958	12796	30628
4080.TPE43.1810	1810	928	22480	15738	648	9604	13718	31280
4080.TPE43.1890	1890	963	23865	16709	682	10615	15163	33170
4080.TPE43.1970	1970	1013	24230	17010	705	11315	16162	33827

Load capacity are stated per single extended slide Axial (Y) & Coaxial (Z) in Newtons

Options: Various dimensions of the main profile, slide lengths, extensions, drillings and hole centres to customer requirements

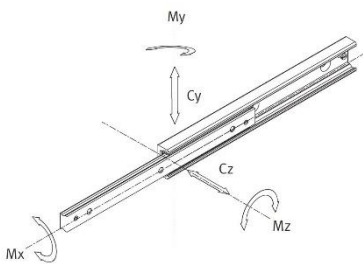

We recommend use the major axis, do not dismantle the slide! The maximum safe load is given for a fully extended pair of slides, mounted on the major axis, with a load spread uniformly along the inner beam.

- Material:** Beams: Cold drawn steel CF53
- Induction hardened raceways 58+4 HRC
- Depth of hardening: Min 0.8mm
- Black zinc passivate corrosion protection
- Four point bearing contact bearings with zero clearance
- Bearings: GCr15 60+4 HRC, Cage material: SPCC
- Two way travel by removal of stop screw
- Max operational temp: 170 degs C (+hi-temp lube)
- Max operating speed: 0.8 m/s
- We recommend external stops are used during operation

'UK Company, Global Reach'