

**SOWS040**

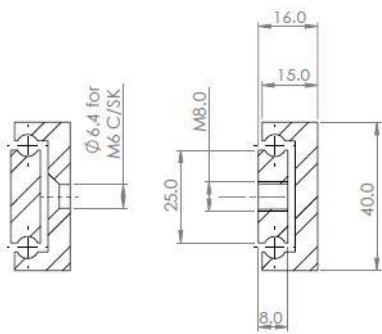
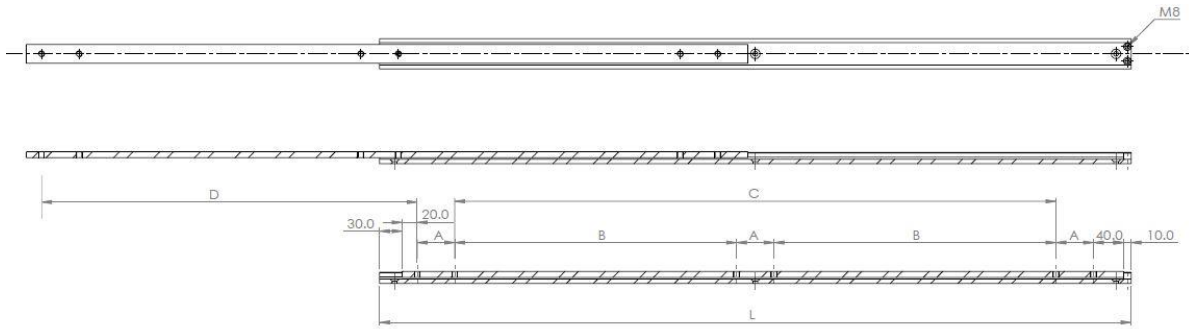

**Mounting details**  
Refer to drill table hole pitches

Configuration Table					
Part Number	Installation Length "L"	Extension Length "D"	Load Per Pair (kg)	Drill Table	
				"A"	"B" "C"
4015.SOWS040.0200	200	100	185	50	
4015.SOWS040.0250	250	125	195	50	50
4015.SOWS040.0300	300	150	205	50	100
4015.SOWS040.0350	350	175	215	50	150
4015.SOWS040.0400	400	200	225	50	200
4015.SOWS040.0450	450	225	235	50	250
4015.SOWS040.0500	500	250	245	50	300
4015.SOWS040.0550	550	275	250	50	150
4015.SOWS040.0600	600	300	245	50	175
4015.SOWS040.0650	650	325	235	50	200
4015.SOWS040.0700	700	350	225	50	225
4015.SOWS040.0750	750	375	215	50	250
4015.SOWS040.0800	800	400	200	50	275
4015.SOWS040.0850	850	425	190	50	300
4015.SOWS040.0900	900	450	180	50	325
4015.SOWS040.0950	950	475	170	50	350
4015.SOWS040.1000	1000	500	160	50	375
4015.SOWS040.1050	1050	525	150	50	400
4015.SOWS040.1100	1100	550	140	50	425
4015.SOWS040.1150	1150	575	130	50	450
4015.SOWS040.1200	1200	600	120	50	475

Options: Various dimensions of the main profile, slide lengths, extensions, drillings and hole centres to customer requirements



We recommend use the major axis, do not dismantle the slide! The maximum safe load is given for a fully extended pair of slides, mounted on the major axis, with a load spread uniformly along the inner beam.



- Material:** All stainless steel parts
- Beams:** Stainless 316L (1.4404) cold drawn & precision milled
- Ball bearings:** Stainless 316L (1.4404)
- Ball cages:** Stainless 430 Ferritic (1.4016)
- End bolts:** Stainless A2 304 (1.4301)
- Surface treatment:** Polished
- Temperature range:** Cryogenic to ~800° C with suitable lubrication & material yield strength reduction

PROFESSIONAL RANGE Stainless Steel