

Ultio 7040

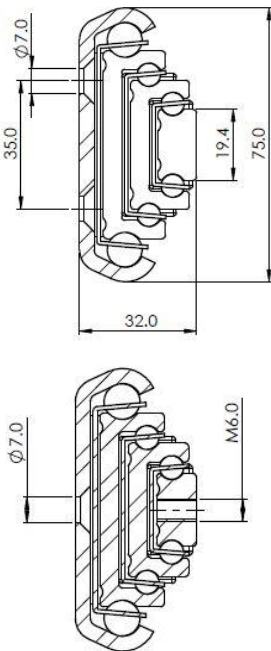

Configuration Table							
Part Number	Installation Length "A"	Extension Length "B"	Load Per Pair (kg)	Drill Table			
				"C"	"D"	"E"	"F"
4005.7040.0300	300	450	150		185		292.5
4005.7040.0350	350	525	184		235		342.5
4005.7040.0400	400	600	212	160	285	200	392.5
4005.7040.0450	450	675	224	185	335	225	442.5
4005.7040.0500	500	750	232	210	385	250	492.5
4005.7040.0550	550	825	240	235	435	275	542.5
4005.7040.0600	600	900	250	260	485	300	592.5
4005.7040.0650	650	975	235	285	535	325	642.5
4005.7040.0700	700	1050	220	310	585	350	692.5
4005.7040.0750	750	1125	200	335	635	375	742.5
4005.7040.0800	800	1200	180	360	685	400	792.5
4005.7040.0850	850	1275	160	385	735	425	842.5
4005.7040.0900	900	1350	140	410	785	450	892.5
4005.7040.0950	950	1425	120	435	835	475	942.5
4005.7040.1000	1000	1500	100	460	885	500	992.5

Mounting details
Refer to drill table hole pitches

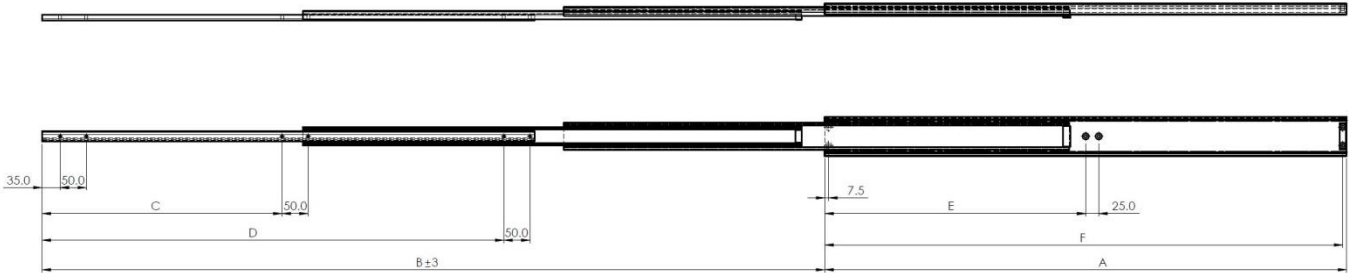

We recommend use the major axis, do not dismantle the slide! The maximum safe load is given for a fully extended pair of slides, mounted on the major axis, with a load spread uniformly along the inner beam.

Options: Various dimensions of the main profile, slide lengths, extensions, drillings and hole centres to customer requirements

Material: Our slides are processed with milling, from cold drawn material in quality C45 in accordance with EN10277. Standard ball cages are manufactured from Stainless Steel. Standard balls used are Stainless Steel, all grade 304.

'UK Company, Global Reach'