

Full traversing is 2 x D when the slide is mounted in the open position

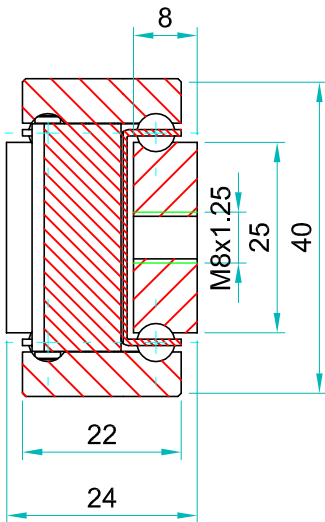

ADTSB-40 weighs 2.24kg/m sold as singles				Hole pattern		
Part Number	Installation Length: L	Extension Length: D	Load per pair: kg	"A"	"B"	"C"
ADTSB040.0200	200	200	85	50		
ADTSB040.0250	250	250	90	50		50
ADTSB040.0300	300	300	95	50		100
ADTSB040.0350	350	350	100	50		150
ADTSB040.0400	400	400	105	50		200
ADTSB040.0450	450	450	110	50		250
ADTSB040.0500	500	500	115	50		300
ADTSB040.0550	550	550	120	50	150	
ADTSB040.0600	600	600	125	50	175	
ADTSB040.0650	650	650	120	50	200	
ADTSB040.0700	700	700	115	50	225	
ADTSB040.0750	750	750	110	50	250	
ADTSB040.0800	800	800	105	50	275	
ADTSB040.0850	850	850	100	50	300	
ADTSB040.0900	900	900	95	50	325	
ADTSB040.0950	950	950	90	50	350	
ADTSB040.1000	1000	1000	85	50	375	
ADTSB040.1050	1050	1050	80	50	400	
ADTSB040.1100	1100	1100	75	50	425	
ADTSB040.1150	1150	1150	70	50	450	
ADTSB040.1200	1200	1200	65	50	475	
ADTSB040.1250	1250	1250	60	50	500	
ADTSB040.1300	1300	1300	55	50	525	
ADTSB040.1350	1350	1350	50	50	550	
ADTSB040.1400	1400	1400	45	50	575	
ADTSB040.1450	1450	1450	40	50	600	
ADTSB040.1500	1500	1500	35	50	625	



Professional Range - Aluminium

Bi-Directional Telescopic Slide

Type: ADTSB-40

Version: 2023/1

ADTSB-40

SLIDING
SYSTEMS

Options:

- 'F' - One mounting beam countersunk
- 'FF' - Both beams countersunk
- 'SA' - Stainless 316L end bolts & retaining pins -
(Subject to manufacturing MOQ: 50 pieces)

**Bespoke length, drilling pattern & extension
on request**



If mounting on the indirect axis, flat, as in the image above, reduce the load capacity by 60-80% and allow for increased deflection, or contact our engineers to request accurate FEA load analysis for OEM projects. We load rate per fully extended pair of slides on the direct axis, upright, with uniform loading across the beams. If load capacities need to be increased, please contact us for technical advice.

Material:

Beams: EN-AW 6082 T6, anodised acc. 8S1615 M10

Ball bearings: Stainless steel AISI-316L (1.4404)

Ball cages: Stainless steel sheet 316L (1.4404). Laser cut for accuracy

End bolts & stopping pins: Stainless steel A2 304 (1.4301)

Surface protection: Anodised to BS 1615 AA10 (max length 1100mm). Lengths 1150mm+ supplied raw, non-anodised.

Temperature range: We recommend -40 to +200° C with low/high-temp lubrication and free movement to allow for expansion.

Lubrication: We apply and recommend lithium based EP3 grease for general applications. High & low temp grease upon request

Thread pitches: As per end profile image - coarse

Do not dismantle the slide!



The maximum safe working load is stated for a fully extended pair of slides, mounted upright. Use all fixing holes and spread the load evenly across the inner beam.

Flat mounting: Reduce the load by 60-80%.

We recommend the use of strong L brackets for under or floor mount.

Deflection is calculated at approx 1% of the closed length, at or near full load capacity.



We do not recommend standard ADTSB slides on automated/variable robotic pick & place or high speed shuttles. Factory adaptation and customer in situ testing is necessary. Operating speeds <0.3m/s. Consult our engineers

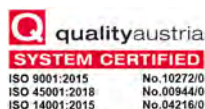

'Global Company, Global Reach'