

Ultio 8027

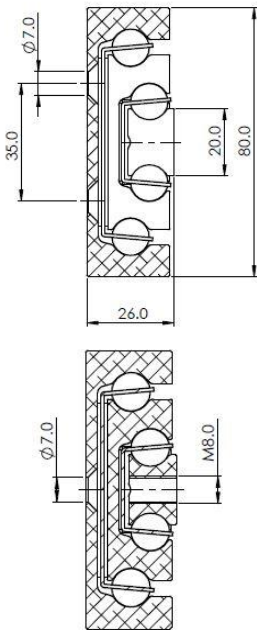

Configuration Table							
Part Number	Installation Length "A"	Extension Length "B"	Load Per Pair (kg)	Drill Table			
				"C"	"D"	"E"	"F"
4005.8027.0300	300	285	250		185	150	292.5
4005.8027.0350	350	335	260		235	175	342.5
4005.8027.0400	400	385	270		285	200	392.5
4005.8027.0450	450	435	280		335	225	442.5
4005.8027.0500	500	485	300		385	250	492.5
4005.8027.0550	550	535	320	235	435	275	542.5
4005.8027.0600	600	585	330	260	485	300	592.5
4005.8027.0650	650	635	315	285	535	325	642.5
4005.8027.0700	700	685	300	310	585	350	692.5
4005.8027.0750	750	735	290	335	635	375	742.5
4005.8027.0800	800	785	280	360	685	400	792.5
4005.8027.0850	850	835	270	385	735	425	842.5
4005.8027.0900	900	885	260	410	785	450	892.5
4005.8027.0950	950	935	250	435	835	475	942.5
4005.8027.1000	1000	985	240	460	885	500	992.5
4005.8027.1200	1200	1185	200	560	1085	600	1192.5
4005.8027.1500	1500	1485	130	710	1385	750	1492.5

Mounting details
Refer to drill table hole pitches

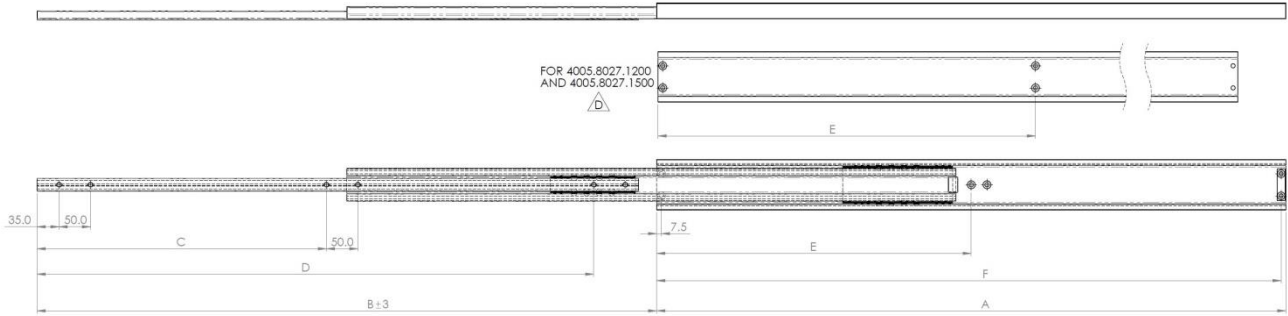

We recommend use the major axis, do not dismantle the slide! The maximum safe load is given for a fully extended pair of slides, mounted on the major axis, with a load spread uniformly along the inner beam.

Options: Various dimensions of the main profile, slide lengths, extensions, drillings and hole centres to customer requirements

Material: The 8027 slide is manufactured from aircraft grade 7005 T53 temper strength, extruded aluminium sections. Bearings, ball cages and non-aluminium components are all 304 Stainless Steel. The beams are anodised, self colour.

'UK Company, Global Reach'