

RADIAL RANGE: Telescopic

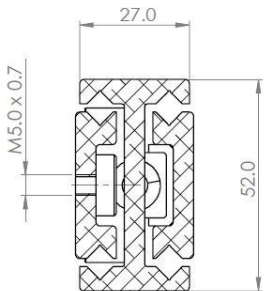

Configuration Table					
Part Number	Installation Length "L"	Extension Length "C"	Load Per Pair (kg)	Drill Table	
				"A"	"B"
4013.5229.0300	300	275	175	120	3
4013.5229.0350	350	375	177	145	3
4013.5229.0400	400	405	180	113	4
4013.5229.0450	450	435	185	130	4
4013.5229.0500	500	535	190	110	5
4013.5229.0550	550	495	195	122.5	5
4013.5229.0600	600	595	200	135	5
4013.5229.0650	650	555	220	118	6
4013.5229.0700	700	655	200	128	6
4013.5229.0750	750	755	185	138	6
4013.5229.0800	800	855	175	148	6
4013.5229.0850	850	815	165	158	6
4013.5229.0900	900	915	155	168	6
4013.5229.0950	950	1015	145	178	6
4013.5229.1000	1000	1115	135	188	6

Mounting details
Refer to drill table hole pitches

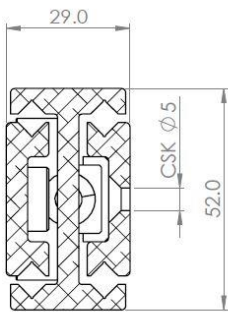

We recommend use the major axis, do not dismantle the slide! The maximum safe load is given for a fully extended pair of slides, mounted on the major axis, with a load spread uniformly along the inner beam.

AS9100-D release available for this product

- Beams: Aluminium grade 6005a milled for accuracy. Clear anodised as standard
- Rollers: Chromed steel. Cross rollers for rigidity
- Cages: Plated steel. Laser cut for accuracy
- High impact shock spring stops
- Lubrication: Berulub FR 16 B. (Range: -50 – 140 °C) High temp on request
- Standard lengths & extensions from 300 – 1000mm
- Special lengths, drillings & black surface finish subject to MOQ
- Operating temperatures between -40 – +200 °C (with nylon parts removed)
- All steel components without spring stops for value production subject to MOQ